

Steel Pipe Flange Dimensions

ANSI B 16.5-1981
ANSI Class 150 RF, Class 300 RF

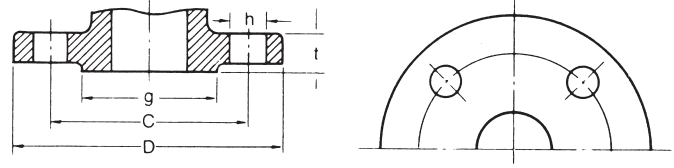

Class 150 steel pipe flange dimensions

Nominal Size		D		C		g		t		(h) Bolt hole*		Bolt	
in	mm	in	mm	in	mm	in	mm	in	mm	in	mm	Number	Diam
1/2	15	3.50	89	2.38	60.5	1.38	35	0.44	11.2	0.62	16	4	1/2
3/4	20	3.88	98	2.75	70.0	1.69	43	0.50 (0.44)	12.7 (11.2)	0.62	16	4	1/2
1	25	4.25	108	3.12	79.5	2.00	51	0.56 (0.44)	14.3 (11.2)	0.62	16	4	1/2
1 1/4	32	4.62	117	3.50	89.0	2.50	64	0.62 (0.50)	15.9 (12.7)	0.62	16	4	1/2
1 1/2	40	5.00	127	3.88	98.5	2.88	73	0.69 (0.56)	17.5 (14.3)	0.62	16	4	1/2
2	50	6.00	152	4.75	120.5	3.62	92	0.75 (0.62)	19.1 (15.9)	0.75	19	4	5/8
2 1/2	65	7.00	178	5.50	139.5	4.12	105	0.88 (0.69)	22.3 (17.5)	0.75	19	4	5/8
3	80	7.50	190	6.00	152.5	5.00	127	0.64 (0.75)	23.9 (19.1)	0.75	19	4	5/8
4	100	9.00	229	7.50	190.5	6.19	157	0.94	23.9	0.75	19	8	5/8
5	125	10.00	254	8.50	216.0	7.31	186	0.94	23.9	0.88	22	8	3/4
6	150	11.00	279	9.50	241.5	8.50	216	1.00	25.4	0.88	22	8	3/4
8	200	13.50	343	11.75	298.5	10.62	270	1.12	28.6	0.88	22	8	3/4
10	250	16.00	406	14.25	362.0	12.75	324	1.19	30.2	1.00	25	12	7/8
12	300	19.00	483	17.00	432.0	15.00	381	1.25	31.8	1.00	25	12	7/8
14	350	21.00	533	18.75	476.5	16.25	413	1.38	35.0	1.12	29	12	1
16	400	23.50	597	21.25	539.5	18.50	470	1.44	36.6	1.12	29	16	1
18	450	25.00	635	22.75	578.0	21.00	533	1.56	39.7	1.25	32	16	1 1/8
20	500	27.50	698	25.00	635.0	23.00	584	1.69	42.9	1.25	32	20	1 1/8
24	600	32.00	813	29.50	749.5	27.25	692	1.88	47.7	1.38	35	20	1 1/4

.Height of raised face is 0.06 inch (1.6mm)each. Dimensions in () are for valve flanges.

*Size 2",3" and 4" of Class 150 trunnion mounted ball valves ae provided with tapped holes which are allowed by API 6D.

Class 300 steel pipe flange dimensions

Nominal Size		D		C		g		t		(h) Bolt hole		Bolt	
in	mm	in	mm	in	mm	in	mm	in	mm	in	mm	Number	Diam
1/2	15	3.75	95	2.62	66.5	1.38	35	0.56	14.3	0.62	16	4	1/2
3/4	20	4.62	117	3.25	82.5	1.69	43	0.62	15.9	0.75	19	4	5/8
1	25	4.88	124	3.50	89.0	2.00	51	0.69	17.5	0.75	19	4	5/8
1 1/4	32	5.25	133	3.88	98.5	2.50	64	0.75	19.1	0.75	19	4	5/8
1 1/2	40	6.12	156	4.50	114.5	2.88	73	0.81	20.7	0.88	22	4	3/4
2	50	6.50	165	5.00	127.0	3.62	92	0.88	22.3	0.75	19	8	5/8
2 1/2	65	7.50	190	5.88	149.0	4.12	105	1.00	25.4	0.88	22	8	3/4
3	80	8.25	210	6.62	168.0	5.00	127	1.12	28.6	0.88	22	8	3/4
4	100	10.00	254	7.88	200.0	6.19	157	1.25	31.8	0.88	22	8	3/4
5	125	11.00	279	9.25	235.0	7.31	186	1.38	35.0	0.88	22	8	3/4
6	150	12.50	318	10.62	270.0	8.50	216	1.44	36.6	0.88	22	12	3/4
8	200	15.00	381	13.00	330.0	10.62	270	1.62	41.3	1.00	25	12	7/8
10	250	17.50	444	15.25	387.5	12.75	324	1.88	47.7	1.12	29	16	1
12	300	20.50	521	17.75	451.0	15.00	381	2.00	50.8	1.25	32	16	1 1/8
14	350	23.00	584	20.25	514.5	16.25	413	2.12	54.0	1.25	32	20	1 1/8
16	400	25.50	648	22.50	571.5	18.50	470	2.25	57.2	1.38	35	20	1 1/4
18	450	28.00	711	24.75	628.5	21.00	533	2.38	60.4	1.38	35	24	1 1/4
20	500	30.50	775	27.00	686.0	23.00	584	2.50	63.5	1.38	35	24	1 1/4
24	600	36.00	914	32.00	813.0	27.25	692	2.75	69.9	1.62	41	24	1 1/2

Height of raised face is 0.06 inch (1.6mm)each.